

2023 Micro-Grant Symposium

Estimating Best Locations for Piezoelectric Panels

Using campus footsteps to generate electricity

What are Piezoelectric Panels?

Piezoelectric power generation refers to the technology of converting kinetic energy to electricity.

Regenerative Thrust for a Living Campus:

Movement → Electricity

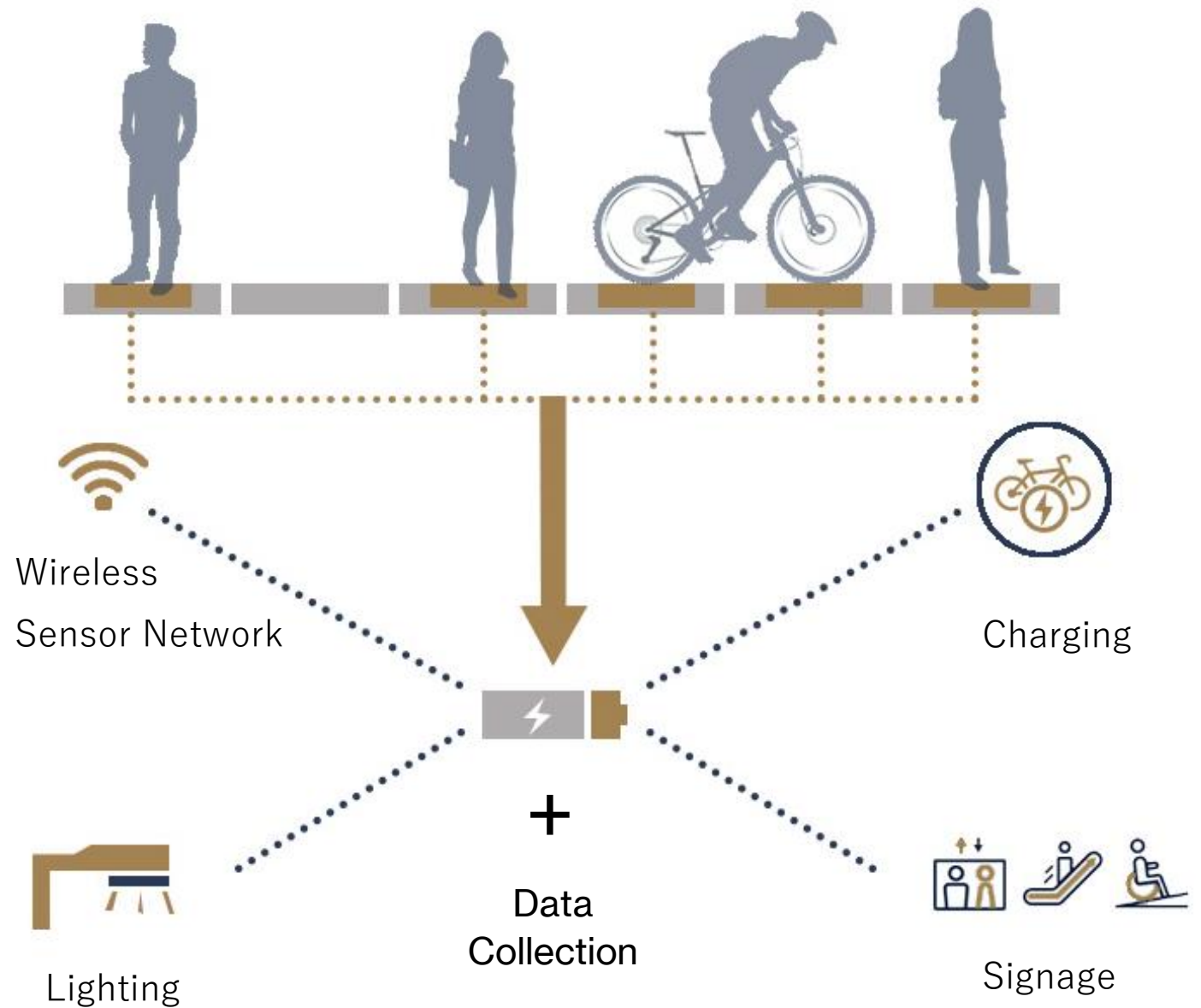

Examples



Japan Railway Company Ticket Turnstiles

135 lbs./ step → 0.1 Watts

Station lighting and Ticketing Machines



Pavegen – London & Hong Kong Quayside

Per Step → 5 Watts

Real-time occupancy and Community lighting



**Kennedy Space Center
Interactive Installation**

**In development under
Library Media Bridge**



How do we Identify the Best Locations?



The Nodes

Visual Assays.

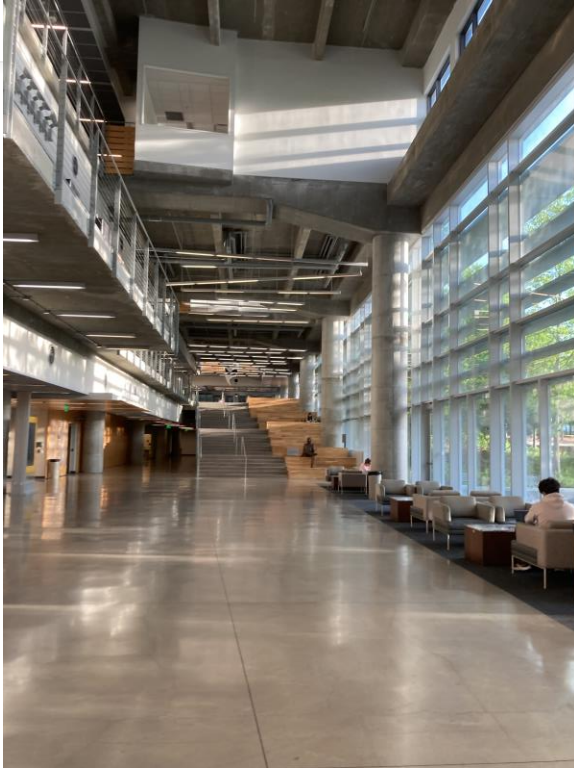

Clough Commons Commons



Tech Green Perimeter

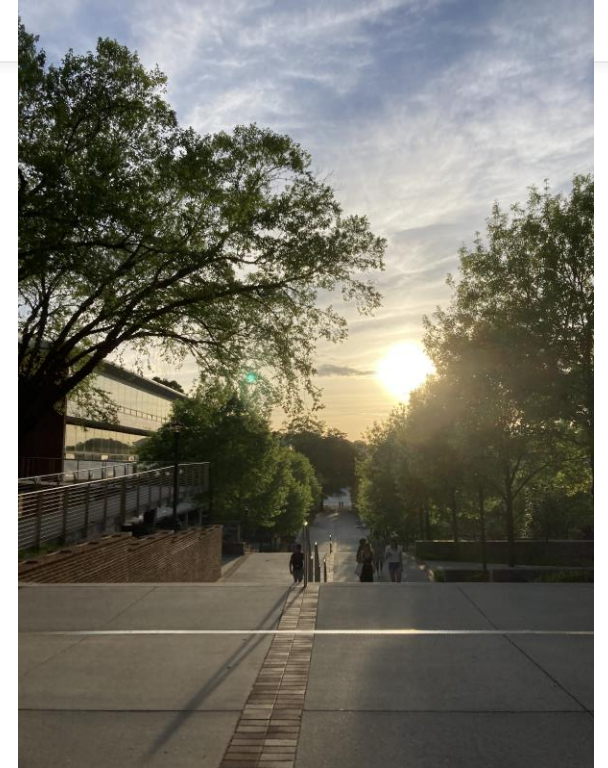

Student Center Walkway

Comparison of Methods

Entrance Sensor Estimation



- Privacy
- Accuracy
- Indoor / Outdoor

GPS Individual Tracking



- Privacy
- Accuracy - Outdoors
- Indoor / Outdoor

Building / Route Density Estimation



- Privacy
- Accuracy
- Indoor / Outdoor

Building Density Estimation

Kendeda Spring 23

Class Time & Volume Data



Segregate by Start & End Time



Collate by Hour



Ingress & Egress Volume in Steps **X**
Generation Capacity of one Panel



Hourly Generation Capacity

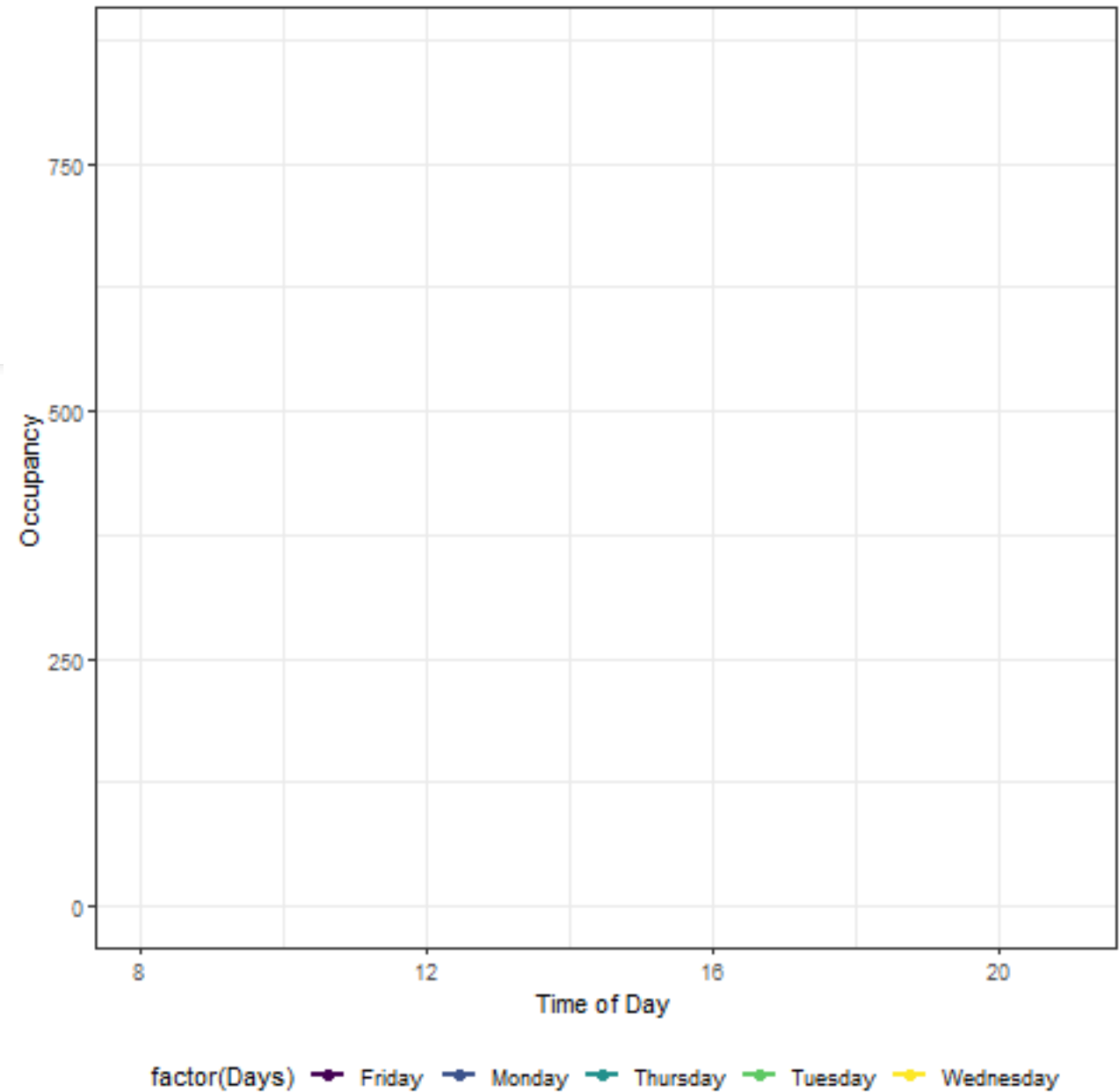

Building Density Estimation

Kendeda Spring 23

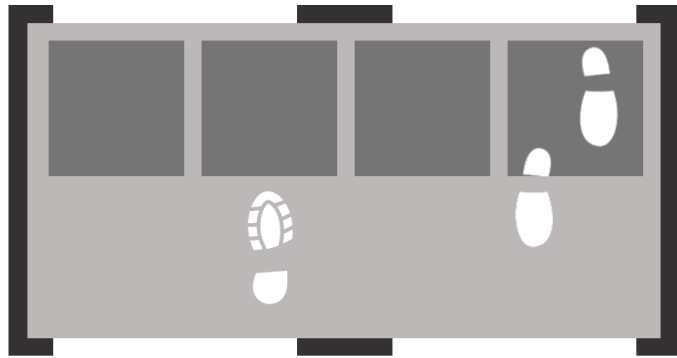

Maximum force on Piezo-panels in a foyer can be estimated with certainty to be highest at times of egress and ingress



Spring 22

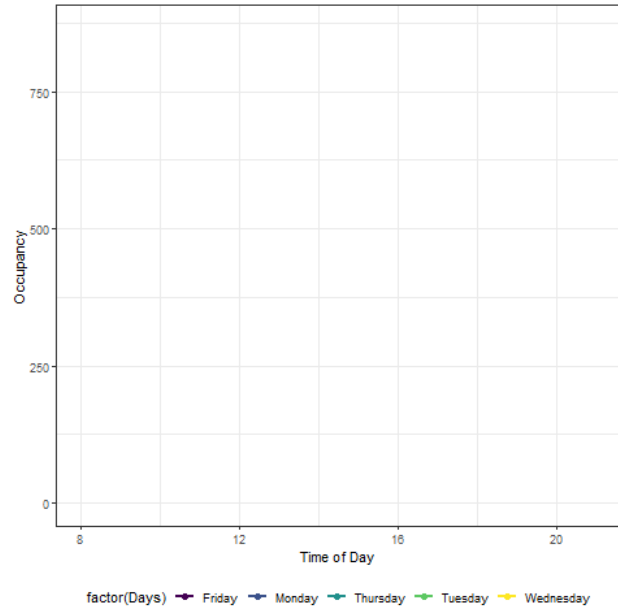

Fall 22

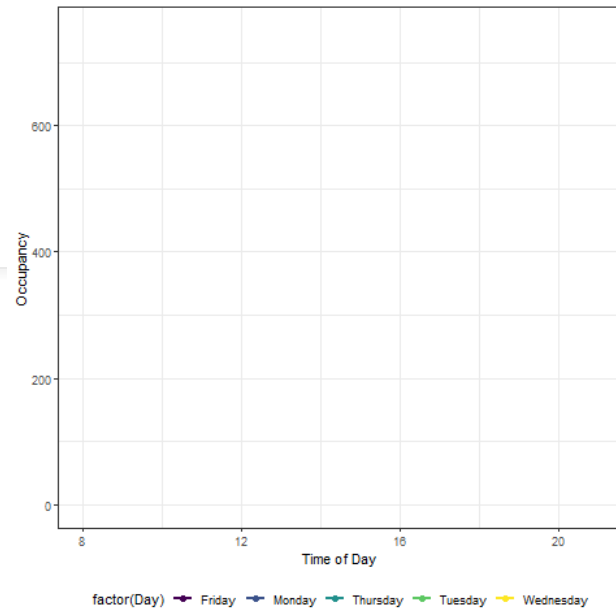

Spring 23

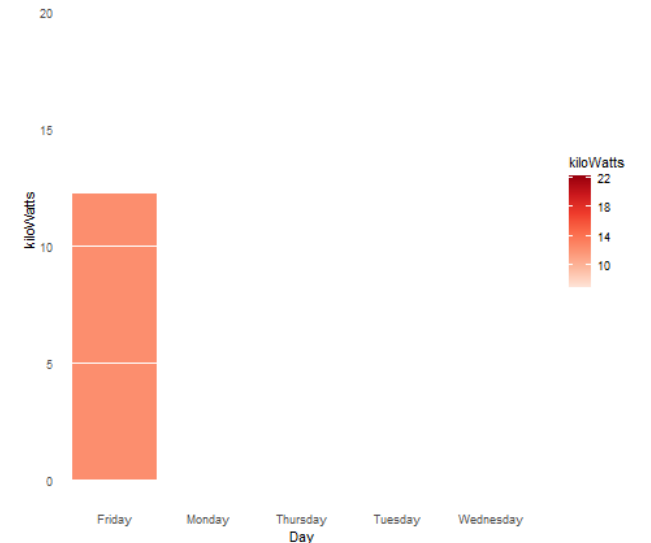
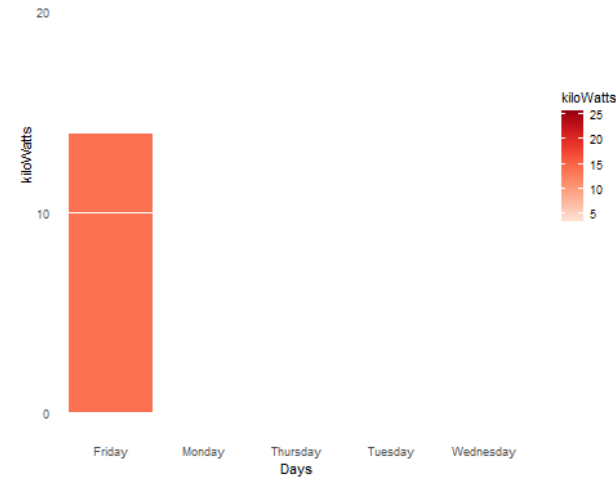
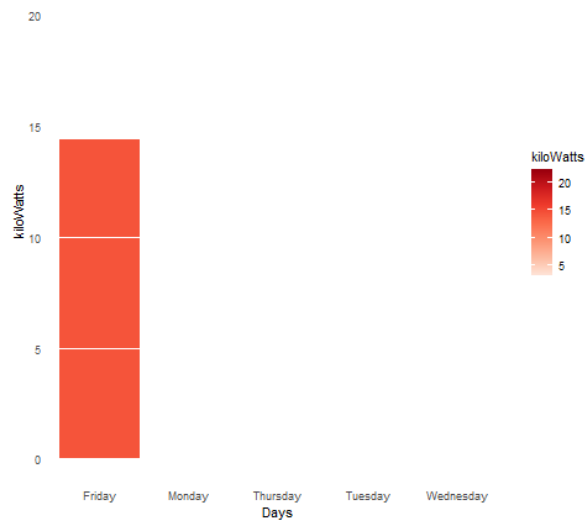
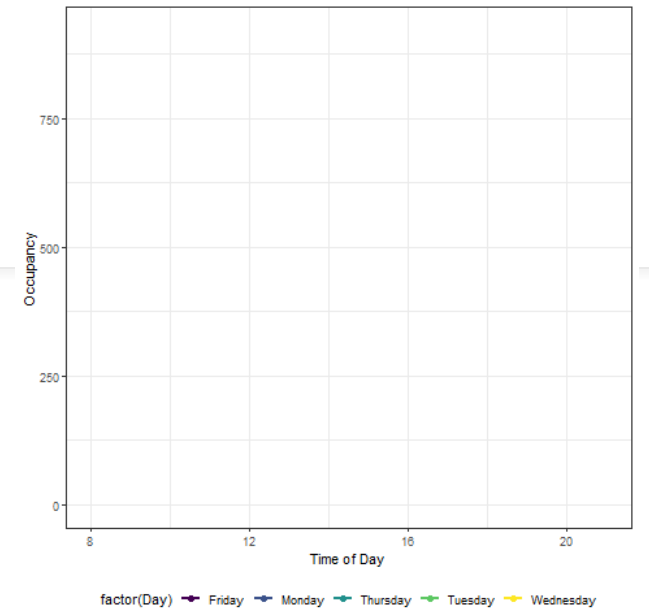



The Edges

Shortest Routes

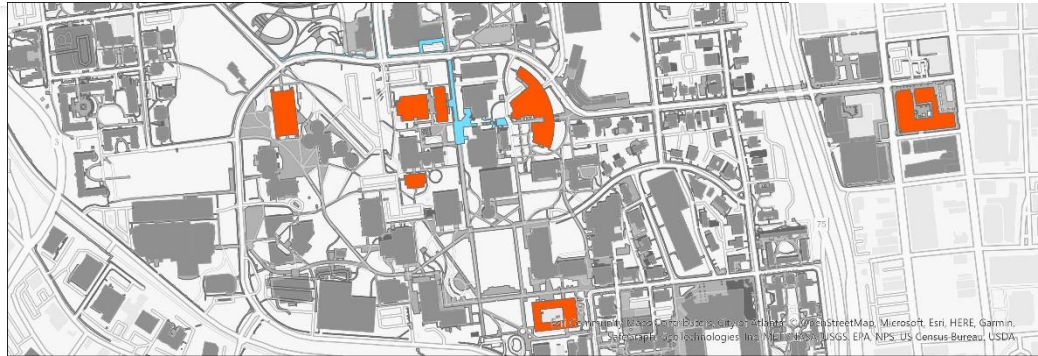

Friday

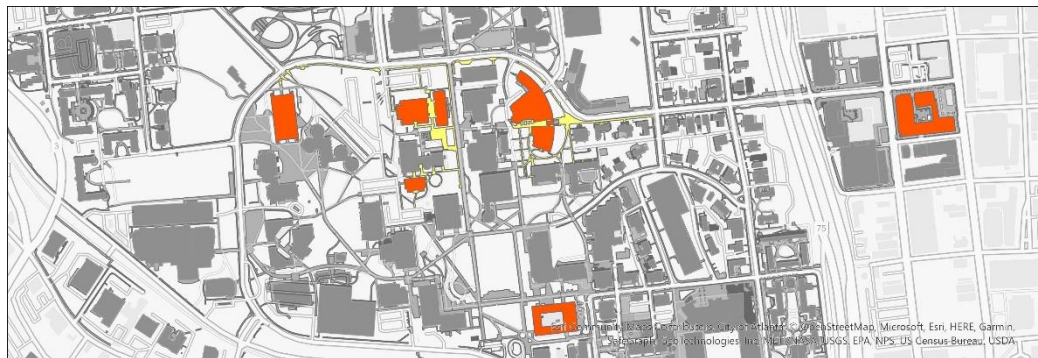

Mon / Wed

Individual Student Schedule



Extract Time & Location Data



Create Shortest Paths



Stineman Interpolation of Intermediate Locations



Overlay Paths by Time



Identify Dense Intersections

Shortest Routes

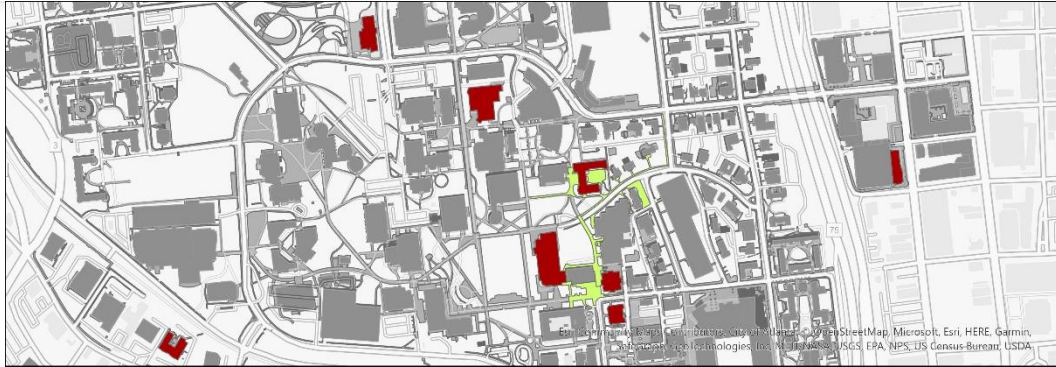

Tue / Thurs

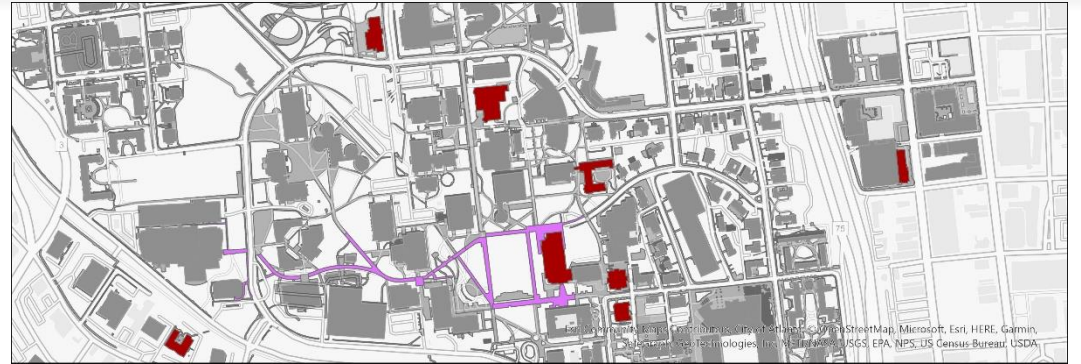

Monday



Friday



Mon / Wed

Route Density Estimation

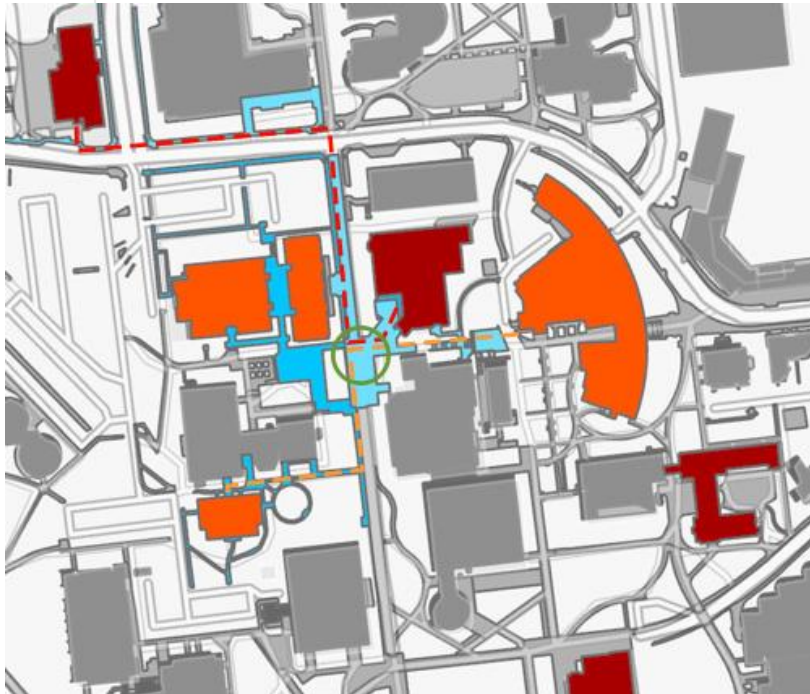

Spatial (Friday 1 – 2 PM)

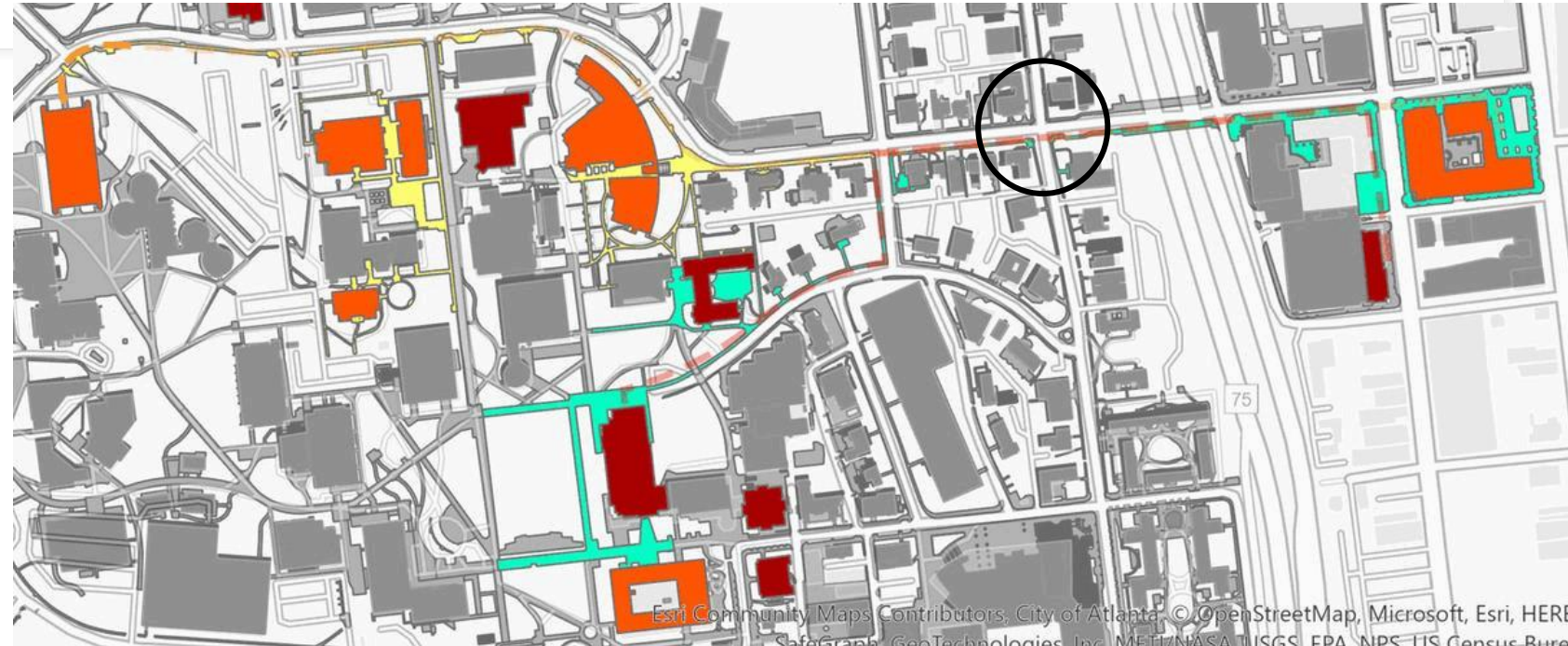

Spatio – Temporal (Mon / Wed 12 – 1 PM)



= Density Map for Sidewalks

Macro-Scale



Meso-Scale



Micro-Scale

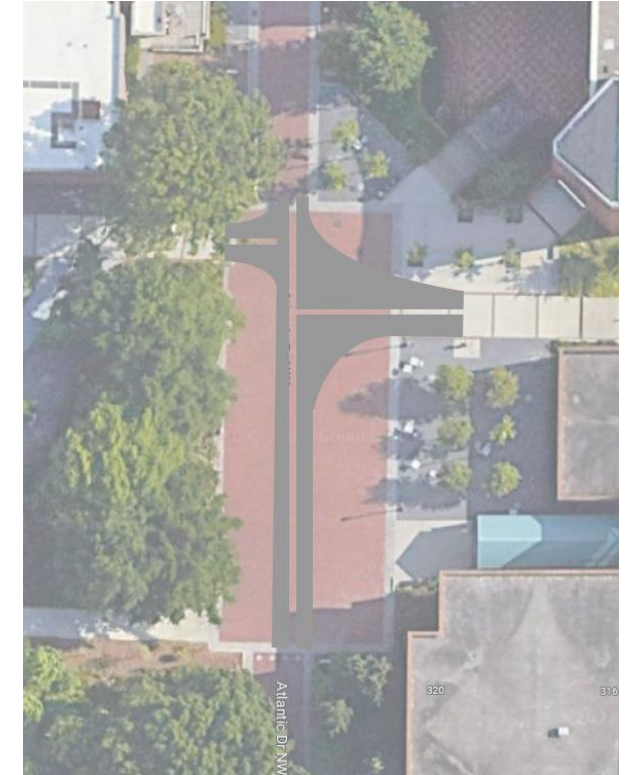
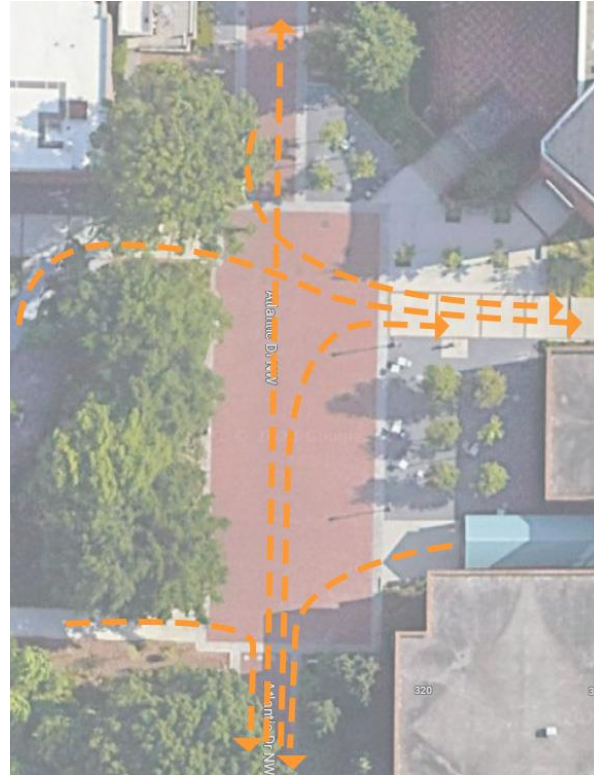

Piezo-Electric Panel Layout as Desire Paths



Georgia Tech: What else can we do with it?

Event Planning / Outreach Programs

Safety Planning

Shading & Public Seating -
Micro Scale Factors

Create a Sensor Feedback Loop



Acknowledgements

Doug Sims

Huang Xiao

Jason K Gregory

Kamilah A Roberts

Laurence Brennan

Shan Arora

Siddharth Sivakumar

ssivakumar60@gatech.edu